



FAST CONNECT FLOODLIGHT INSTRUCTION MANUAL

Congratulations on your purchase of Major Tech's fast connect floodlights! This product saves you installation time and the additional cost for accessories normally needed for the installation of traditional floodlights. These floodlights have a fast connect system which allows for quick and direct termination of your power cable to the flood light through the newly designed termination block and cable gland providing strain relief and IP65 moisture protection. This new design eliminates the need for ferrules, connector strips or external junction boxes saving costs and time in the installation process. This floodlight has a 1.5kV surge protection to assist during electrical spikes and fluctuations. Please note that certain extreme events or repeat surges on different occasions may cause the floodlight to be permanently damaged. All electrical work must be carried out by a suitably qualified professional.

Installation Instructions:

- Step 1:** Isolate the circuit you are working on by turning off the circuit breaker.
Step 2: Find your ideal location for the floodlight and drill 5mm holes to mount the bracket.
Step 3: Remove bracket from the light fitting. Mount the bracket onto the wall.
Step 4: Remount the light fitting onto the bracket.

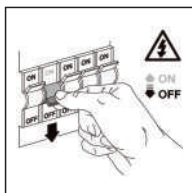

Step 1

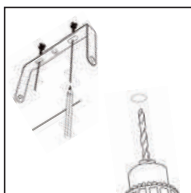

Step 2

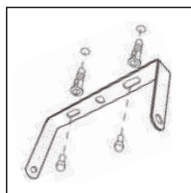

Step 3

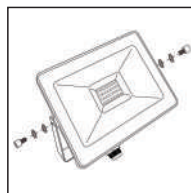

Step 4

- Step 5:** Prepare your power cable by stripping off 14mm of insulation from your live, neutral and earth wires. This will give you the correct amount of exposed conductor on each wire to terminate effectively without creating a loose connection.
Step 6: Unscrew the cable gland from the base of the floodlight housing and then unscrew the bottom compression screw from the gland itself.
Step 7: Feed your prepared wire ends through the compression screw and then through the bottom of the gland.
Step 8: With a flat screwdriver press down on the raised trigger latches on the fast connector block and insert the prepared conductor in to the Live, Neutral and Earth terminals respectively as far as the insulation, so no bare conductor is exposed. Release the trigger and the conductor will be securely locked in place. Check that there are no loose connections by pulling each wire.
Step 9: Push the cable gland and screw it back onto the body of the flood light. Fasten the compression screw to the bottom of the cable gland.
Step 10: Turn the power back on to test that the floodlight has been installed correctly.

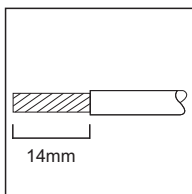

Step 5

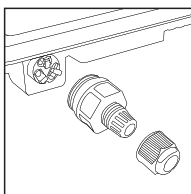

Step 6

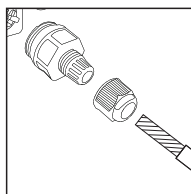

Step 7

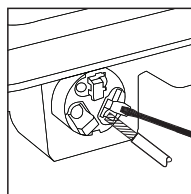

Step 8 & 9

Specifications:

Part Number	Weight	Dimensions	Working Temp	IP Grade	CCT
LFB-50NWC	710g	207x178x34mm	-30 to 40°C	IP65	4000K
ALF100NW	1.25kg	252x182x38mm	-30 to 40°C	IP65	4000K
ALF200NW	2.75kg	397x308x43mm	-30 to 40°C	IP65	4000K



MAJOR TECH (PTY) LTD

South Africa

🌐 www.major-tech.com

✉ sales@major-tech.com

